

Product Specifications

NANE: RF Remote Control LED Single Color Dimmer

MODEL: OB-DIM-RF-LV (L=5,6,12,24)



Summarization

RF dimmer is a controller that can adjust brightness infinitely, its control mode is wireless control, you could adjust light to the appropriate lighting brightness in accordance with your actual need.

Technical parameters

- working temperature: -20-60 °C
- supply voltage: DC5V, 12V, 18V, 24V < optional > (supply voltage should be marked on order)
- output: 1 channel
- net weight: 100g
- gross weight: 130g
- external dimension: L110 X W56 X H34 mm
- packing size: L122X W85 X H42 mm
- rated load current: <8A
- output power: 5V<40W, 12V<96W, 24V<192W

External Dimension

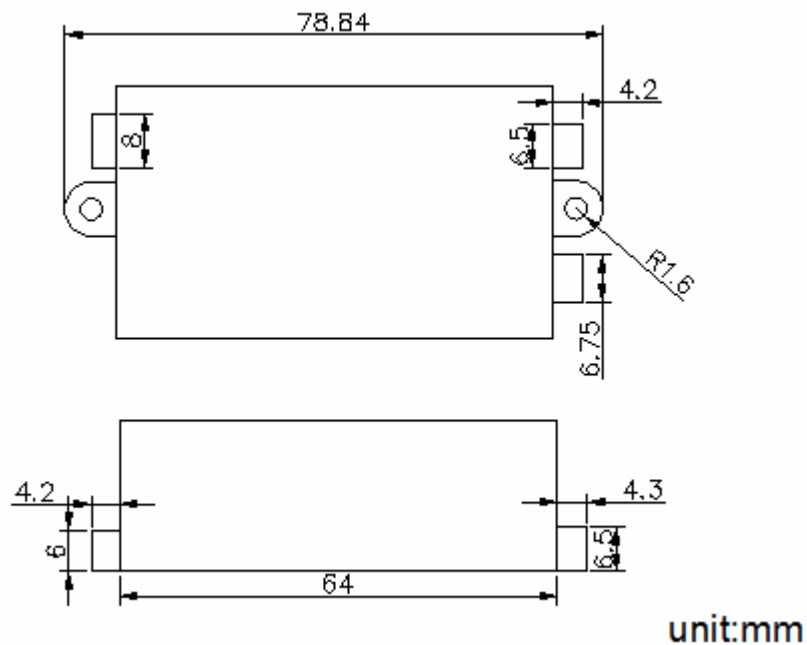

Interface Specifications

input interface:



output interface:



Direction for use

1. Connect the load wire at first, following by the power wire; **Please ensure short circuit can not occur between connecting wire before you turn on the power;**
2. Adopt wireless control, its function as follows:
 - △ key is for increasing brightness,
 - ▽ key is for reducing brightness.

Typical Applications

